

22. Instrument Panel Assembly

A: REMOVAL

CAUTION:

- Refer to “CAUTION” of “General Description” before handling the airbag module. <Ref. to AB-9, CAUTION, General Description.>
- Be careful not to damage the airbag system harness when servicing the instrument panel. Damage may cause the system to malfunction.

NOTE:

Remove the instrument panel assembly and the beam COMPL - steering as a unit.

1) Disconnect the ground cable from battery and wait for at least 60 seconds before starting work. <Ref. to NT-5, BATTERY, NOTE, Note.>

NOTE:

- For models other than STI model, disconnect the ground terminal from battery sensor.
 - On CVT models, shift the select lever into “D” before disconnecting the battery ground cable.
 - For model with the power seat, move the seat to the front-most position before removing the battery ground terminal.
- 2) Remove the console box assembly, the cover - shift lever and the panel center LWR on the RH and LH sides. <Ref. to EI-67, REMOVAL, Console Box.>
 - 3) Remove the cover assembly - instrument panel LWR driver. <Ref. to EI-61, REMOVAL, Instrument Panel Lower Cover.>
 - 4) Remove the cover switch - starter. (Only model without keyless access)
 - (1) Release the claws and remove the cover switch - starter.
 - (2) Disconnect the connector and aspirator hose.

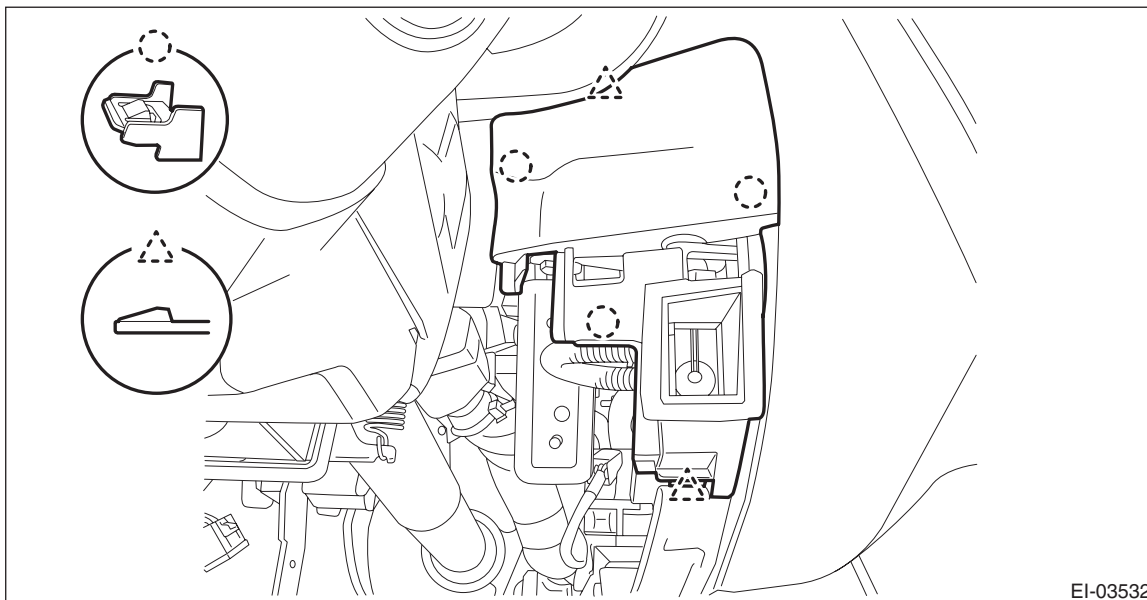

EI-03532

Instrument Panel Assembly

EXTERIOR/INTERIOR TRIM

5) Remove the panel - switch. (Only model with keyless access)

- (1) Release the claw of the switch - push button start, and disconnect the connector.
- (2) Release the claws, and then remove the panel - switch.
- (3) Disconnect the connector and aspirator hose.

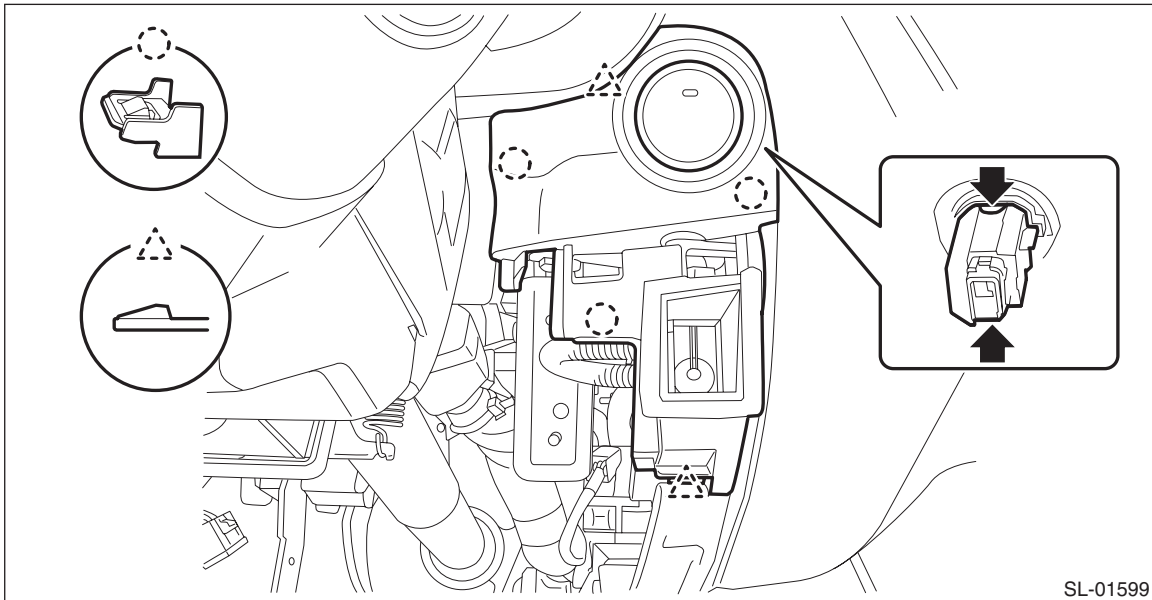

6) Remove the knee airbag module. <Ref. to AB-35, REMOVAL, Knee Airbag Module.>

7) Release the clips and claws, then detach the left and right grille speaker side.

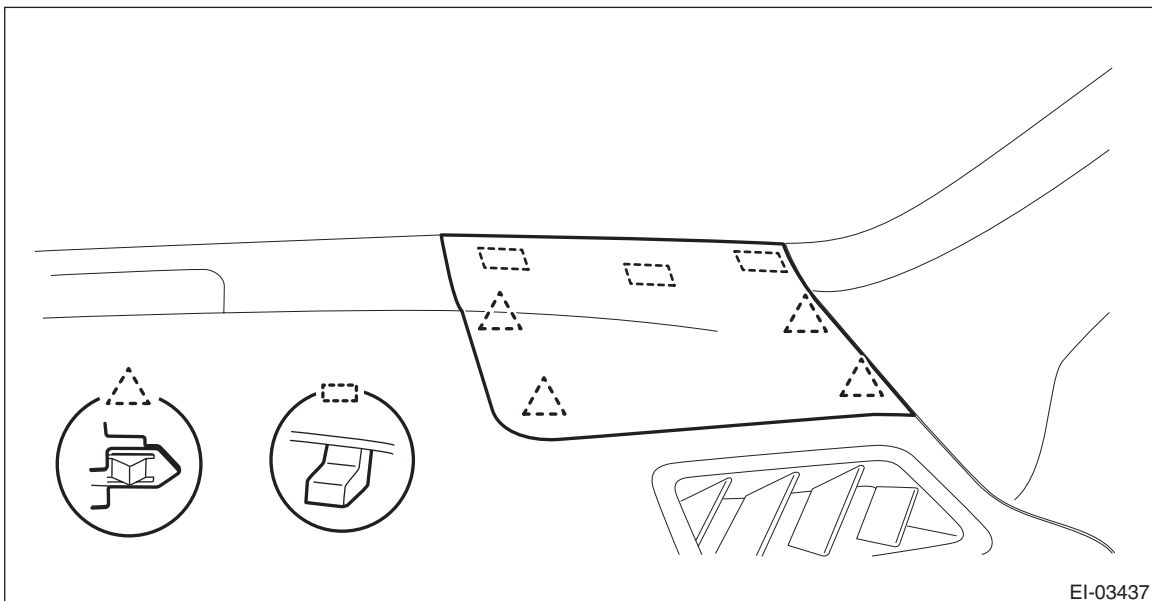

NOTE:

Remove the grille speaker side by using a plastic remover.

8) Remove the trim panel - front pillar UPR on the left and right sides. <Ref. to EI-85, REMOVAL, Upper Inner Trim.>

9) Remove the glove box assembly. <Ref. to EI-63, REMOVAL, Glove Box.>

10) Remove the panel center assembly. <Ref. to EI-66, REMOVAL, Center Console.>

11) Remove the audio assembly or navigation assembly.

- Audio ASSY <Ref. to ET-8, REMOVAL, Audio.>

- Navigation ASSY <Ref. to ET-8, REMOVAL, Audio.>

12) Remove the multi-function display assembly. <Ref. to IDI-20, REMOVAL, Multi-function Display (MFD).>

13) Remove the combination meter assembly. <Ref. to IDI-13, REMOVAL, Combination Meter.>

14) Disconnect the passenger's airbag module connector. <Ref. to AB-19, PASSENGER'S AIRBAG MODULE, PROCEDURE, Airbag Connector.>

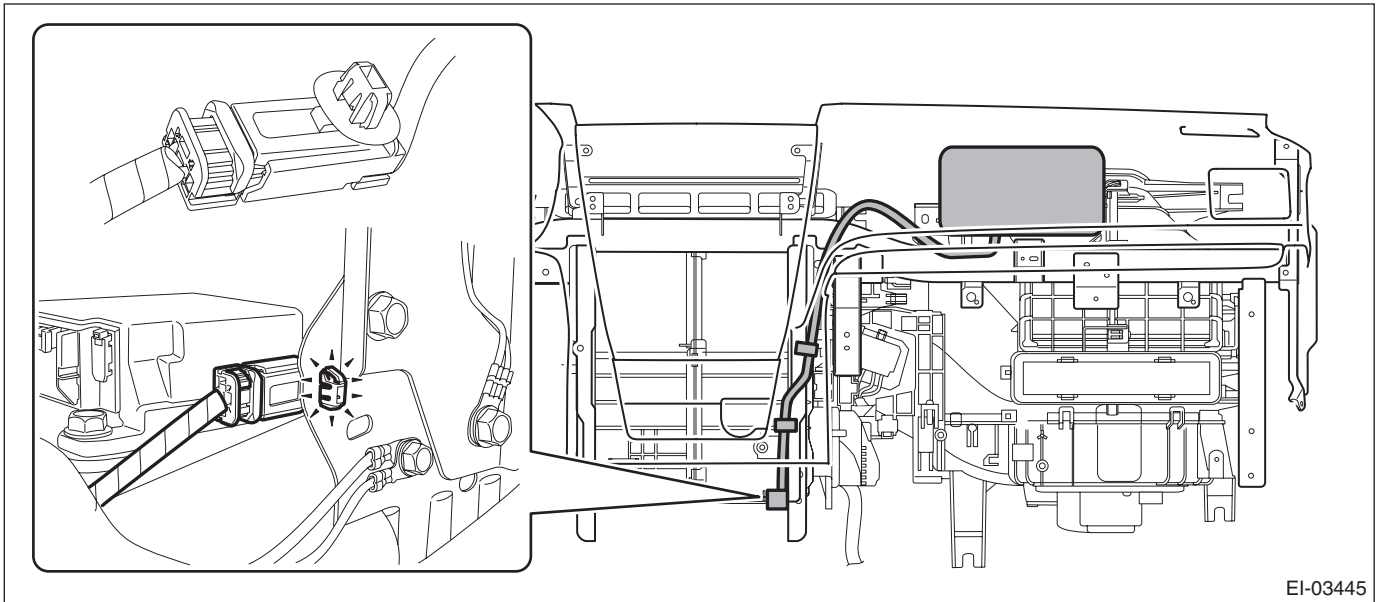

15) Remove the column assembly - steering. <Ref. to PS-25, REMOVAL, Steering Column.>

16) Release the claws, and then remove the cover side sill - front INN and cover side sill - front on the RH and LH sides. <Ref. to EI-81, REMOVAL, Lower Inner Trim.>

17) Remove the body side weather strip - flange front.

18) Remove the instrument panel assembly and the beam COMPL - steering as a unit.

CAUTION:

The instrument panel assembly and the beam COMPL - steering are heavy. Always work in a team of two persons when removing them from the vehicle, so as not to damage the vehicle interior.

- (1) Remove the fuse box and relay box.
- (2) Disconnect all harness clamps and connectors of the instrument panel harness.
- (3) Remove the cap - bolt.
- (4) Remove the TORX® bolt. (a), (b)

Preparation tool:

TORX® T40

- (5) Remove the bolts at the floor center. (c), (d)

Instrument Panel Assembly

EXTERIOR/INTERIOR TRIM

(6) Remove the bolt. (e), (f)

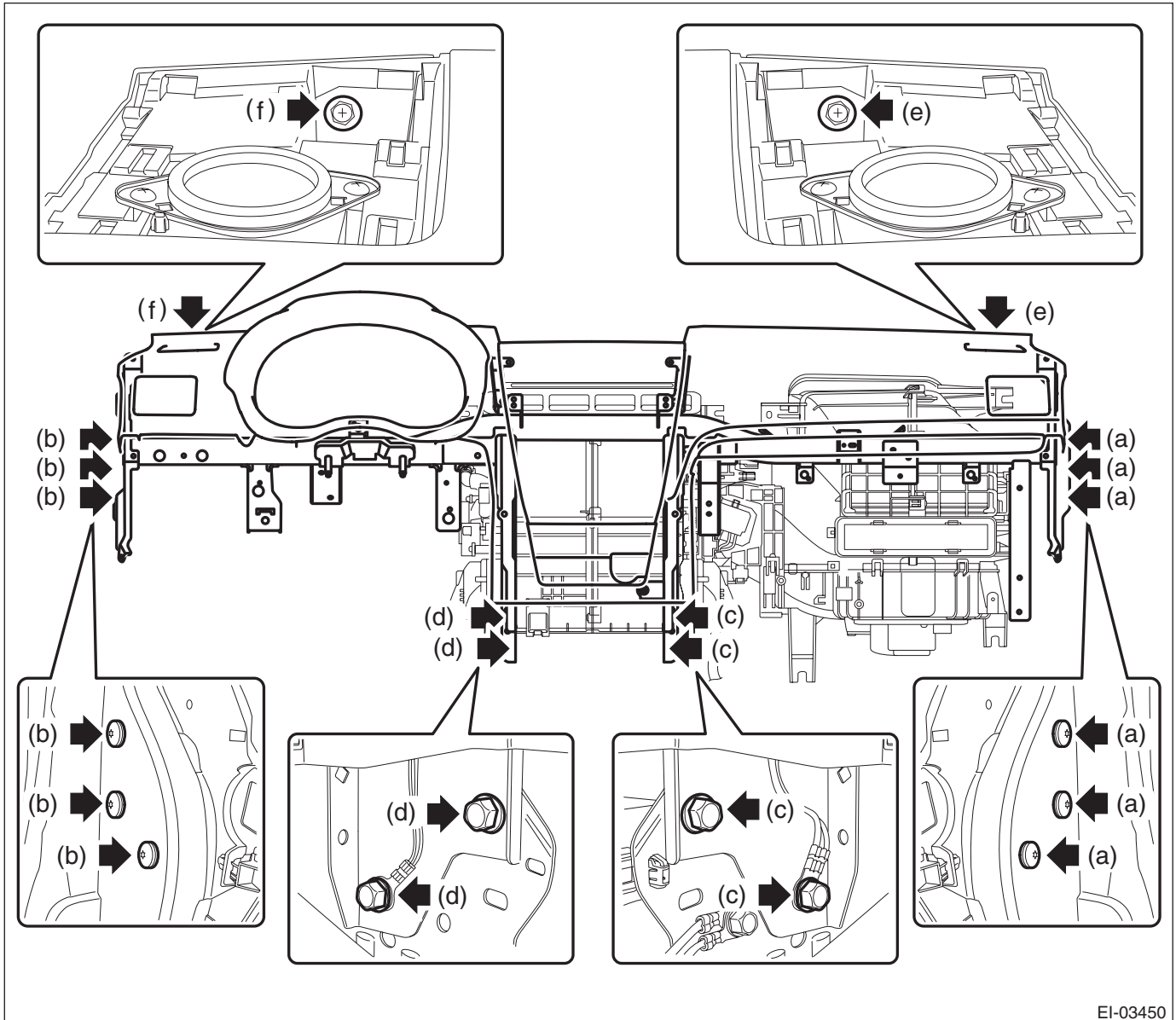

EI-03450

(7) Loosen the adjuster portion (h) of the adjuster - clip space. (only LH side of the beam COMPL - steering)

Preparation tool:

Hexagon wrench: 8 mm (0.31 in)

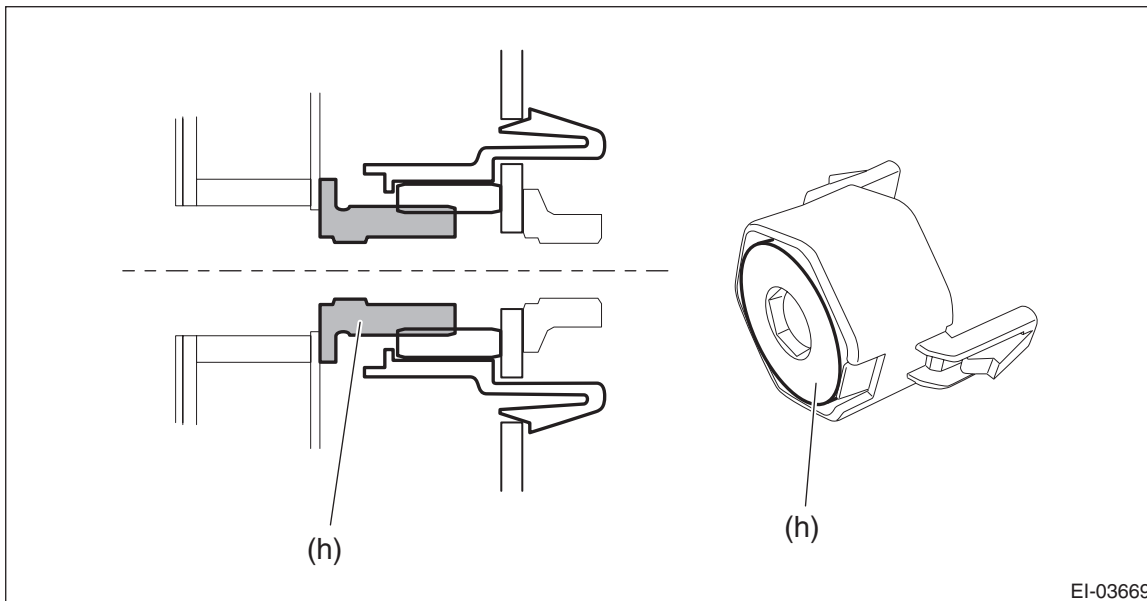

EI-03669

(8) Slightly lift the instrument panel assembly together with the beam COMPL - steering to detach the left and right pins. Then pull it toward you to remove the assembly.

CAUTION:

- Check that all harness clamps and connectors are detached.
- The instrument panel assembly and the beam COMPL - steering are heavy. Always work in a team of two persons when removing them from the vehicle, so as not to damage the vehicle interior.

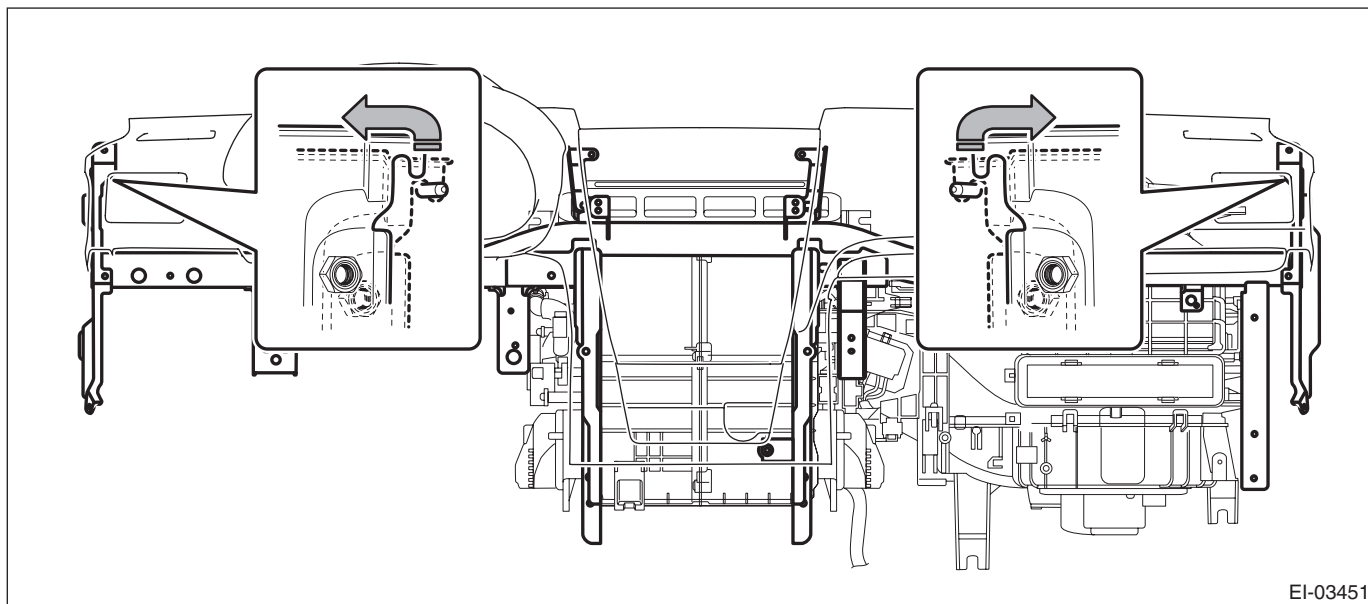

EI-03451

Instrument Panel Assembly

EXTERIOR/INTERIOR TRIM

- 19) Remove the grille front defroster.
- (1) Disconnect the connector of the sensor - sunload.
 - (2) Release the claws and remove the grille front defroster.

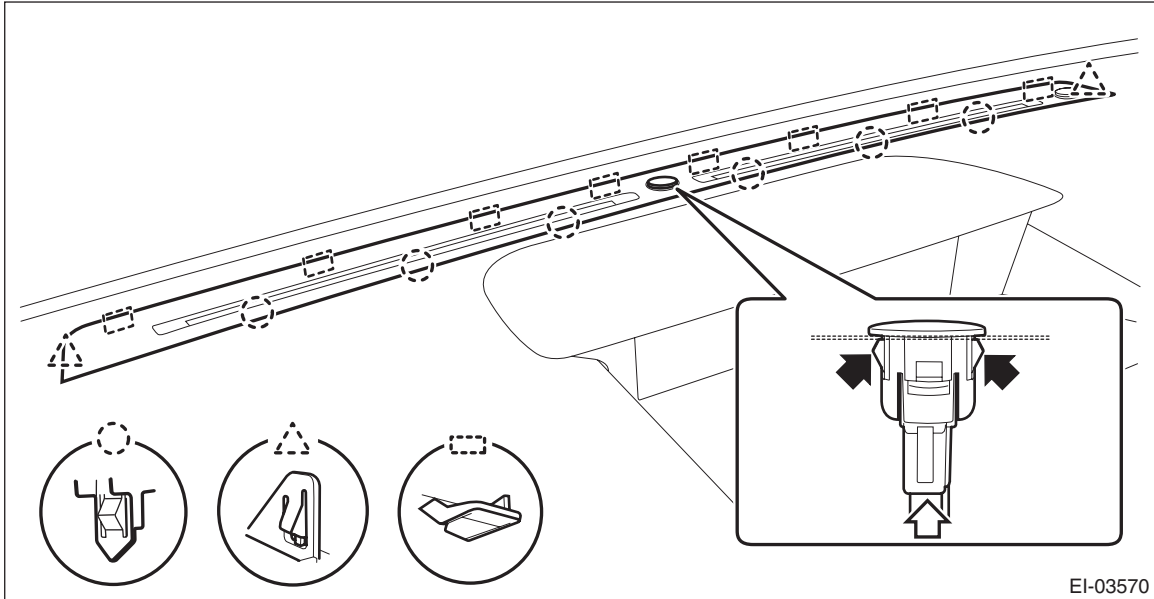

- 20) Remove the screws and remove the front (A) and side vent duct (B) LH, RH.

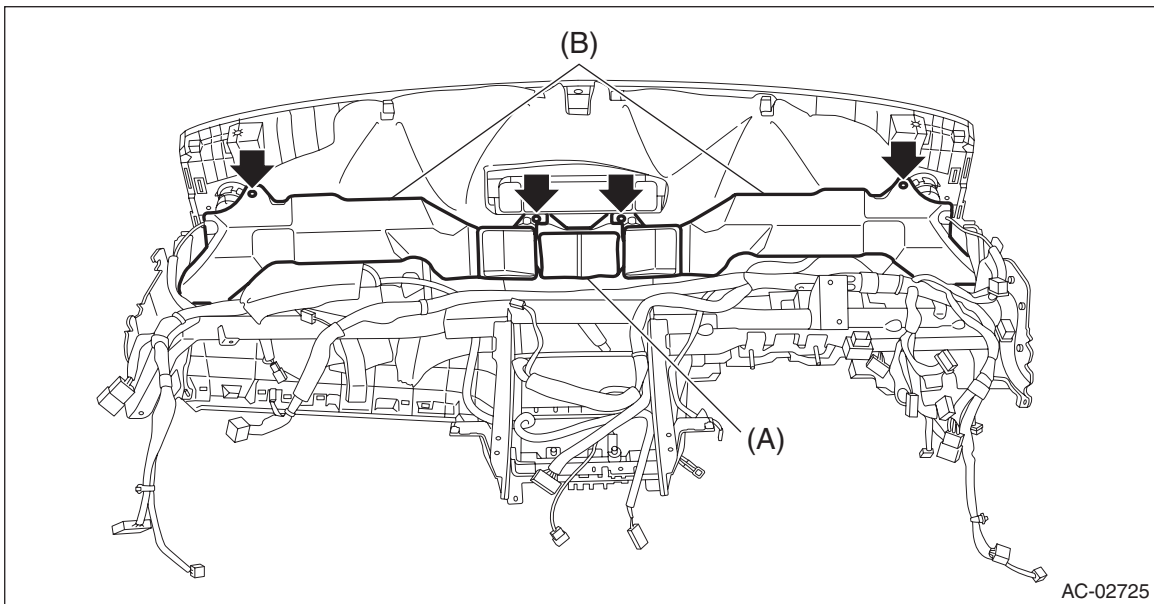

- 21) Separate the panel COMPL - instrument and the beam COMPL - steering.
(1) Remove the clamps and bolts of the passenger's airbag module harness.

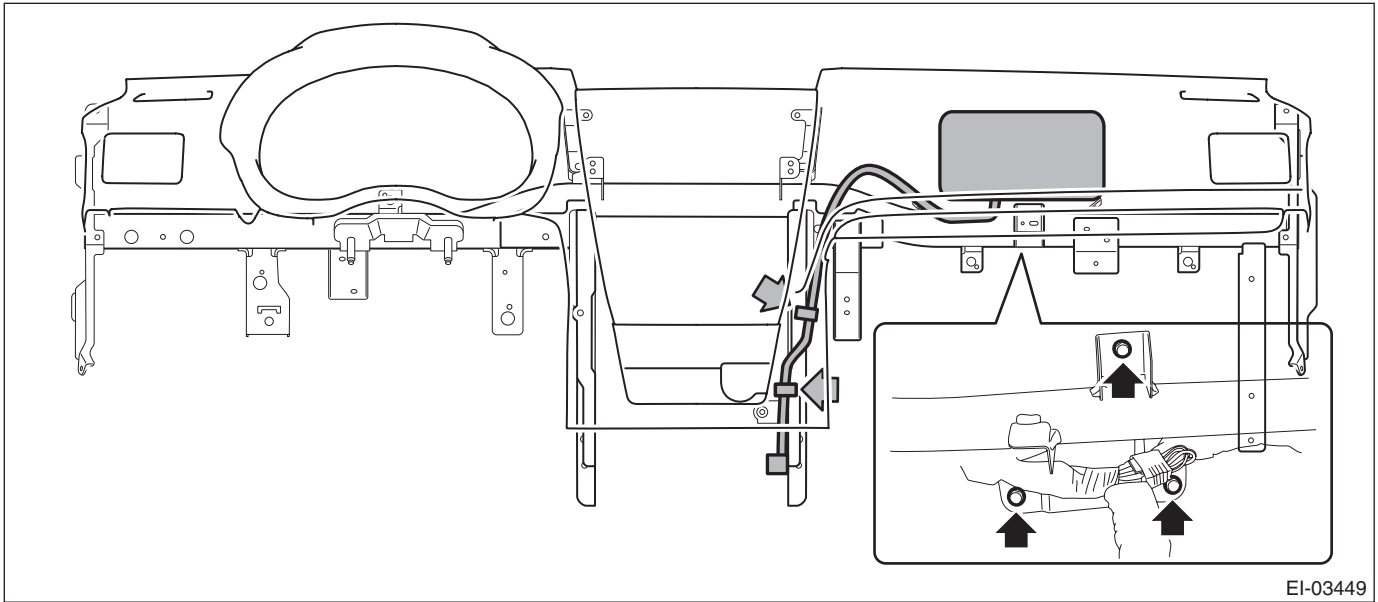

- (2) Remove the left and right speakers.

NOTE:

Detach the harness clamp together.

- (3) Disconnect the front accessory socket connector.
(4) Remove the nut (a) and screws (b), (c), (d), (e), (f), (g) and (h).

Instrument Panel Assembly

EXTERIOR/INTERIOR TRIM

(5) While being careful with the harness, separate the panel COMPL - instrument and the beam COMPL - steering.

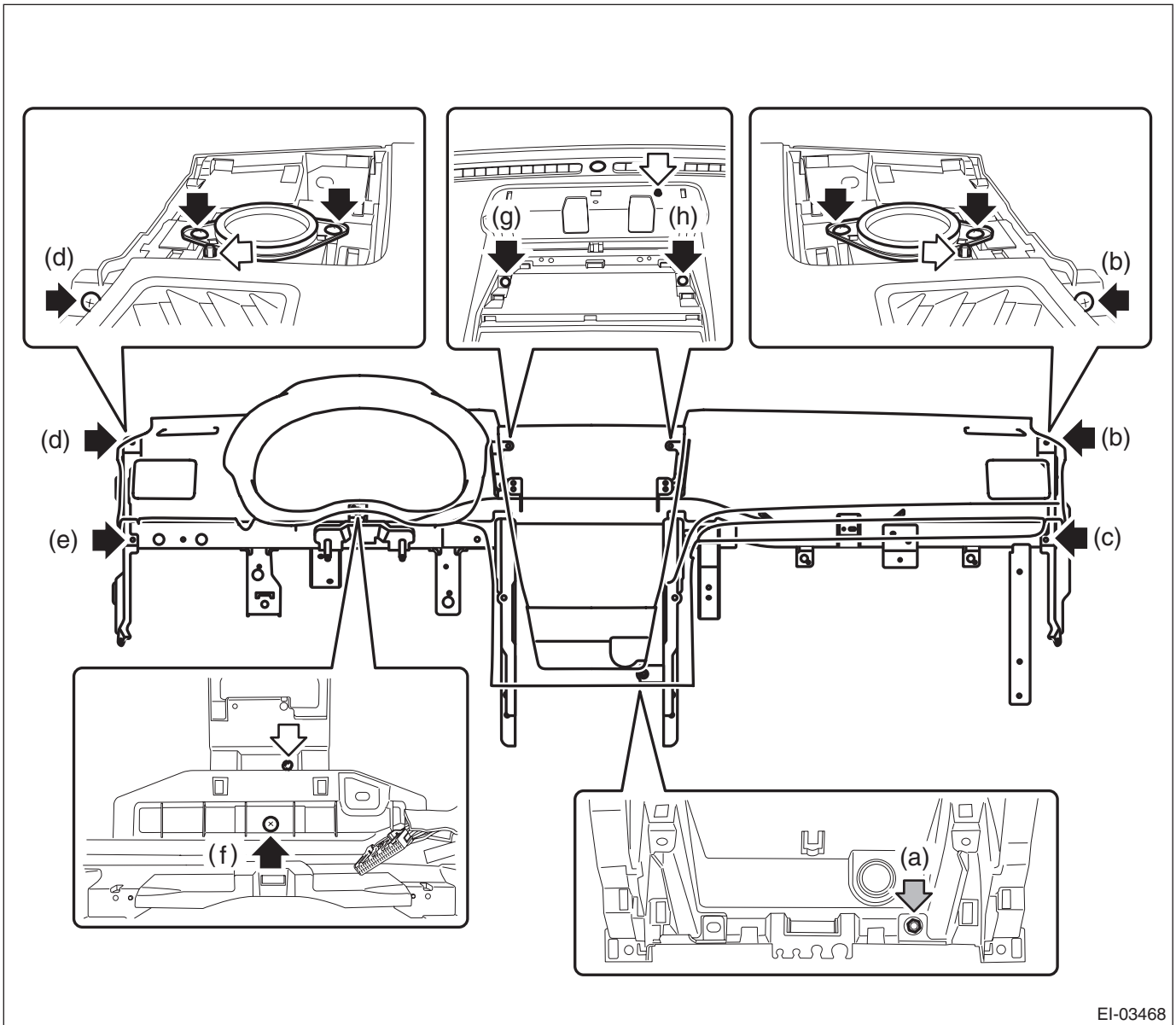

EI-03468

22) Remove the claws, and remove the passenger's airbag module.

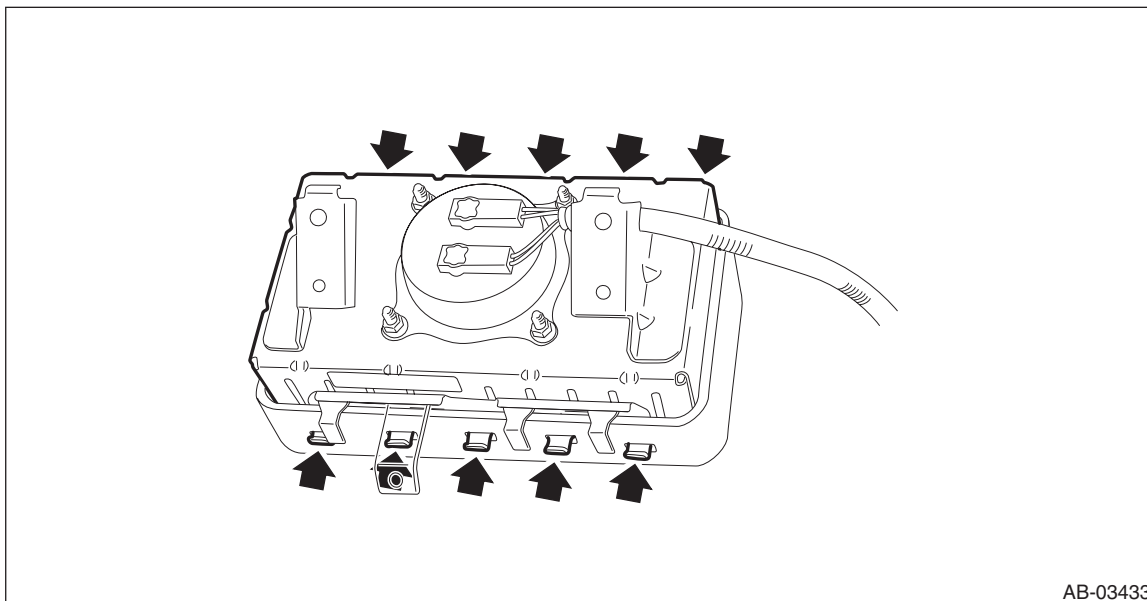

AB-03433

B: INSTALLATION

CAUTION:

- Refer to "CAUTION" of "General Description" before handling the airbag module. <Ref. to AB-9, CAUTION, General Description.>
- After installing the panel center assembly, check that the air vent grille of the panel center assembly is inserted correctly into the air vent duct.
- When installing the cover - instrument panel side (a), make sure that the body side weather strip - flange front does not come inside the panel COMPL - instrument (b).

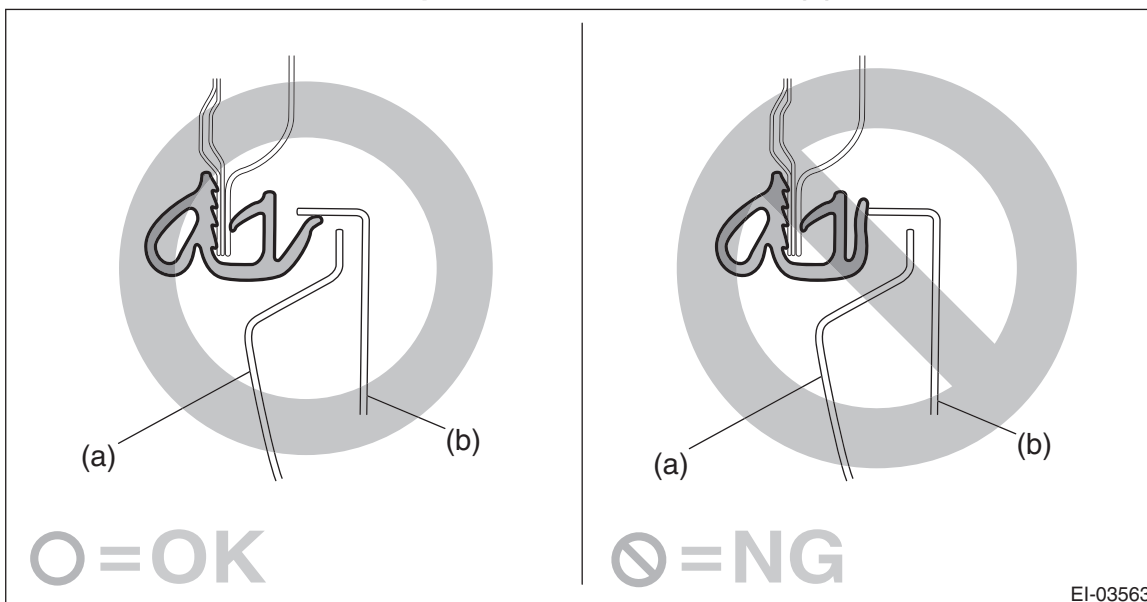

EI-03563

- When reusing the tether clip on the upper part of the trim panel - front pillar UPR, check that there is no damage to the tether clip. If the clip is damaged, its holding force is reduced and the trim panel - front pillar UPR may come off. Be sure to replace it with a new clip.
- Do not reuse the tether clip removed from the upper part of the trim panel - front pillar UPR. Always replace with a new part.

Instrument Panel Assembly

EXTERIOR/INTERIOR TRIM

- Check the installation status of the tether clips and install the trim panel - front pillar UPR.

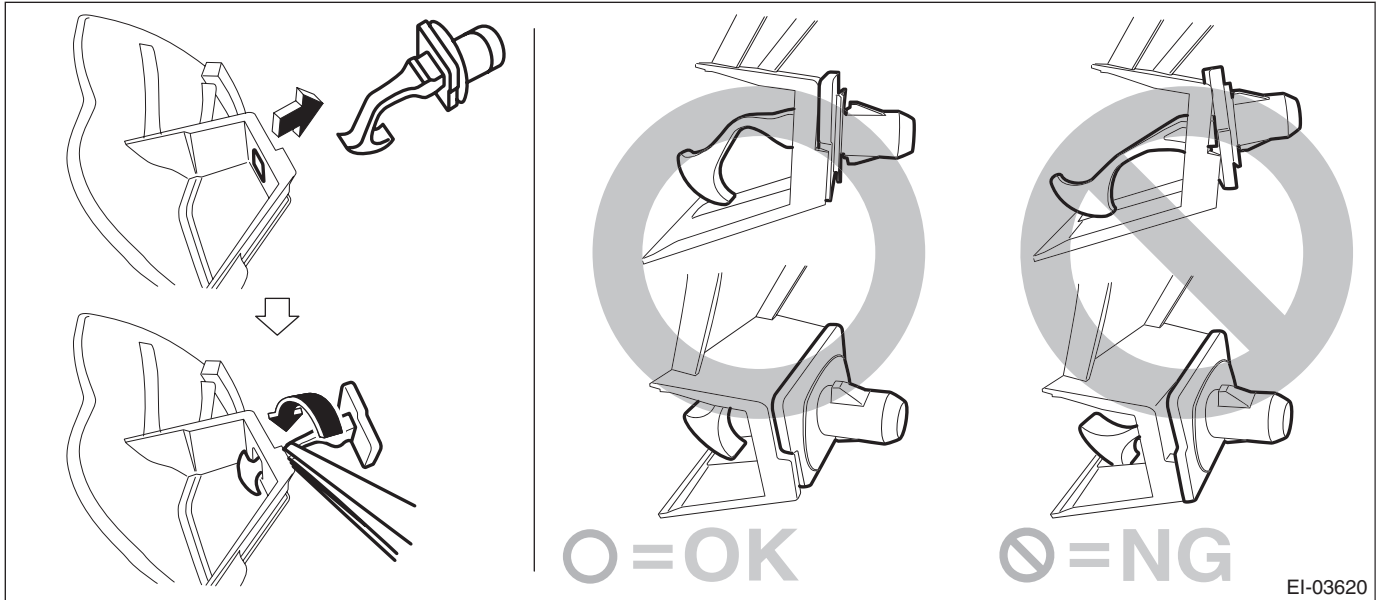

- 1) Attach components until the instrument panel assembly is formed, in the reverse order of removal.

NOTE:

Method of installing insulator

- Adhesive

Use polyurethane adhesive. When assembling the instrument panel assembly, wait until the adhesive has evaporated to prevent filling of the smell in the compartment.

- Double-sided tape

Use commercial double-sided tape. (Use strong double-sided adhesive tape.)

Tightening torque:

Passenger's airbag module: 7.5 N·m (0.8 kgf·m, 5.5 ft·lb)

- 2) Insert the matching pins on the body side (three locations - one in the center and the remaining two on both sides) into the instrument panel assembly and the beam COMPL - steering.

- 3) Check that the matching pins are inserted securely and that the harness is routed properly, and then connect each connector.

- 4) Secure the instrument panel assembly and the beam COMPL - steering to the vehicle body.
 (1) Position the instrument panel assembly and the beam COMPL - steering to the vehicle body and tighten the adjuster - clip space.

Preparation tool:

Hexagon wrench: 8 mm (0.31 in)

NOTE:

Tighten so that there is no gap between the adjuster portion (h) and the body.

Tightening torque:

Adjuster - clip space: 0.4 — 4 N·m (0.04 — 0.4 kgf·m, 0.3 — 3 ft·lb)

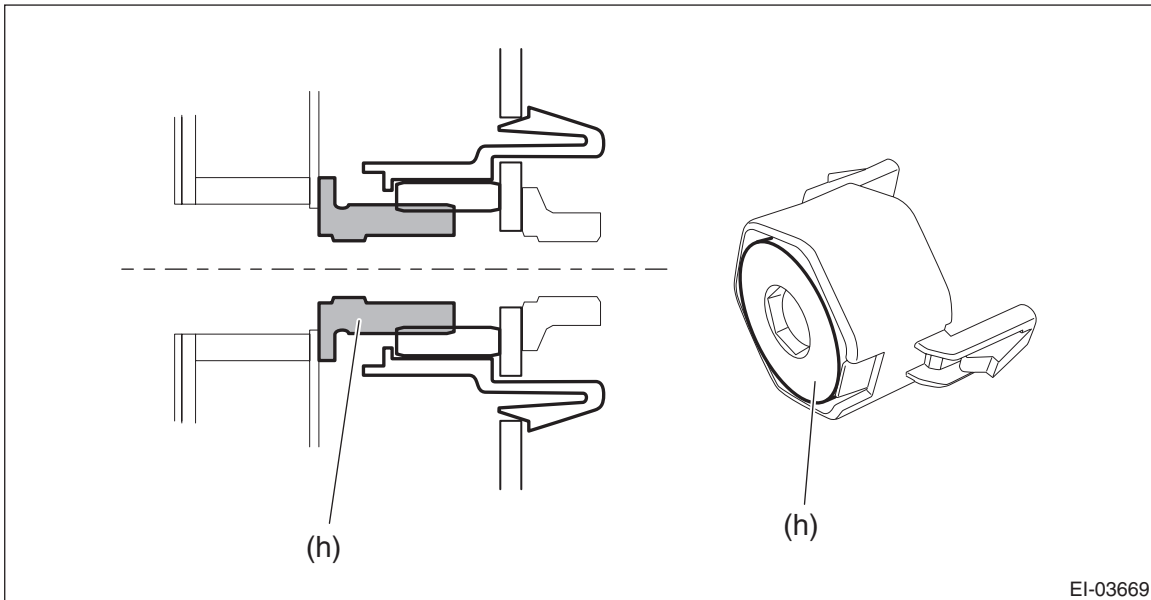

EI-03669

- (2) Temporarily tighten the bolts (a), (b), (c) and (d) of the beam COMPL - steering.

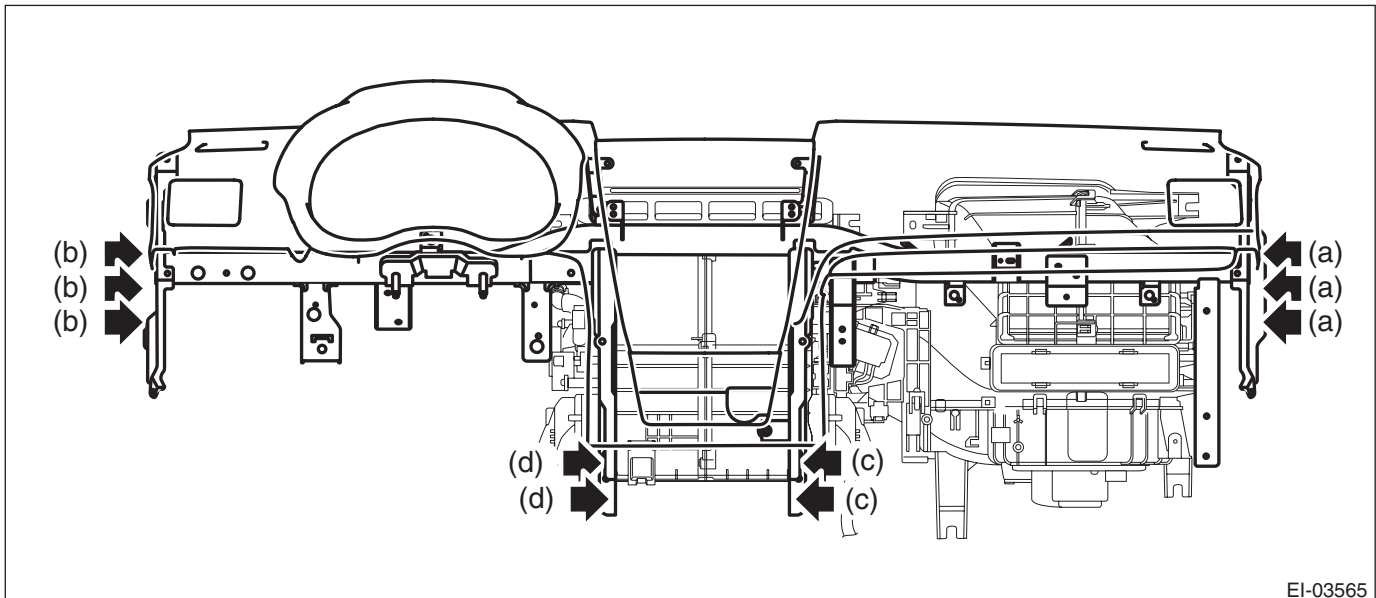

EI-03565

- (3) Tighten the beam COMPL - steering in the order from (a) to (d) to the specified torque.

Tightening torque:

Beam COMPL - steering: 25 N·m (2.5 kgf·m, 18.4 ft·lb)

- 5) Install the body side weather strip - flange front.
 6) Install the cover side sill - front on the RH and LH sides.
 7) Install the cover side sill - front INN on the RH and LH sides.

Instrument Panel Assembly

EXTERIOR/INTERIOR TRIM

8) Install the column assembly - steering.

Tightening torque:

Column assembly - steering: <Ref. to PS-4, STEERING WHEEL AND COLUMN, COMPONENT, General Description.>

9) Install the combination meter assembly.

10) Install the multi-function display assembly.

11) Install the audio assembly or navigation assembly.

12) Install the panel center assembly.

13) Install the globe box assembly.

14) Install the trim panel - front pillar UPR on the RH and LH sides.

15) Install the grille speaker side on the RH and LH sides.

16) Install the knee airbag module.

Tightening torque:

7.5 N·m (0.8 kgf-m, 5.5 ft-lb)

17) Install the panel - switch. (Only model with keyless access)

18) Install the cover switch - starter. (Only model without keyless access)

19) Install the cover assembly - instrument panel LWR driver.

20) Install the panel center LWR on the RH and LH sides.

21) Install the cover - shift lever.

22) Install the console box assembly.

23) Connect the battery ground terminal. <Ref. to NT-5, BATTERY, NOTE, Note.>

NOTE:

For models other than STI model, connect the ground terminal to battery sensor.